



Category: 79GHz Microwave Radar
Blind Spot Detection System

Model No.: SBS-1

Product Photo: **Display** **Sensor**



Package Photo:





Certification:



Includes:



ECU	X	1 pc
Display	X	2 pcs
Microwave sensor	X	2 pcs
Main harness	X	1 pc
Display cable	X	1 pc
Magnet	X	2 pcs
Alcohol pat	X	2 pcs
Sensor location calibration tool (Tear our from packaging)	X	1 pc
Sensor locator card (Tear our from packaging)	X	1 pc
Manual	X	1 pc

General Features:

- 79GHz ultrahigh frequency blind spot detection system with high resolution and fast response speed
- Match with 2 microwave sensors for rear corners blind spot area
- Blind spot detection system available while driving
 - Detection area: 3*5 meters right & left-rear corner of vehicle
- Visual and audial display with optional buzzer ON/OFF
- Adjustable brightness of display

Key Features of DISPLAY:

- Plug-in designed display on dash, and compatible for all cars
- Built in LED light & buzzer
- Patent protected

Key Features of DISPLAY:

- Light-weight sensor stick inside bumper
- No holes needed for bumper
- Special design for curve surface
- Patent protected

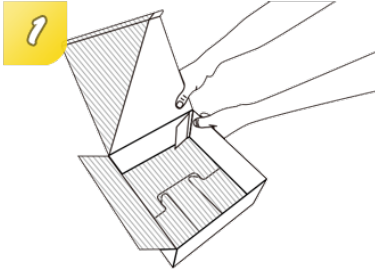

1 Open the white box

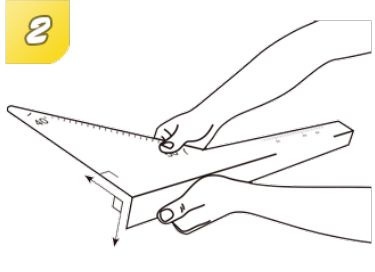

2 Make the sensor location calibration tool

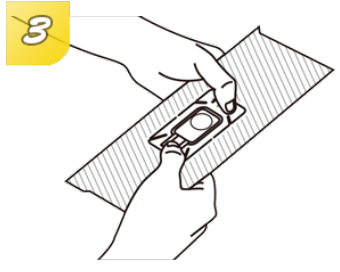

3 Hollow out the sensor locator card

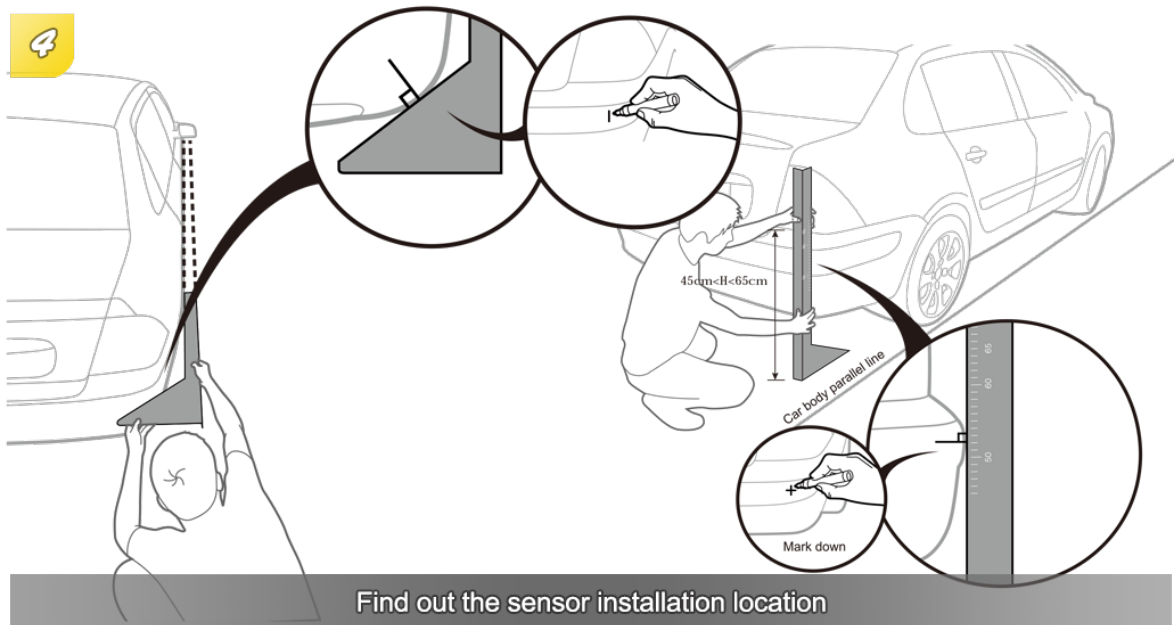

4 Find out the sensor installation location

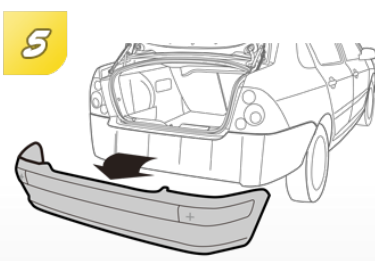

5 Remove the rear bumper

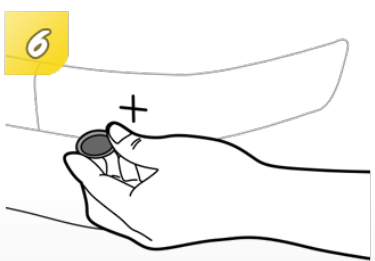

6 Place one magnet on sensor location point

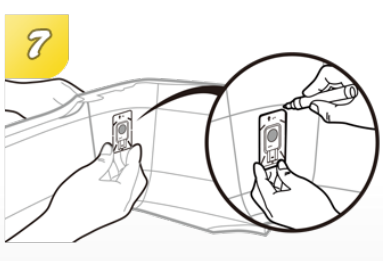

7 Place another magnet with sensor location tool be attached at bumper

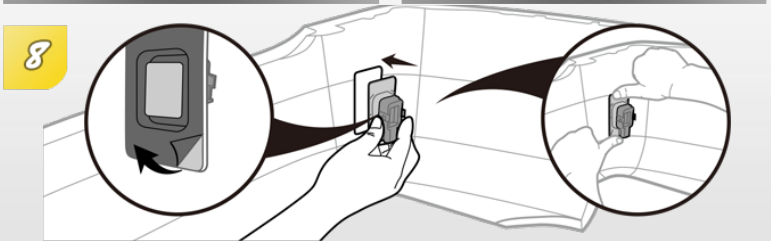

8 Stick the sensor on bumper

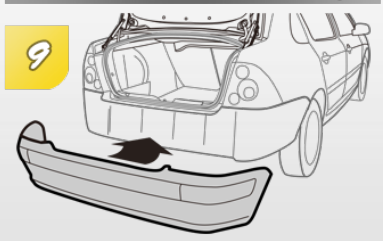

9 Replace the bumper

Installation:

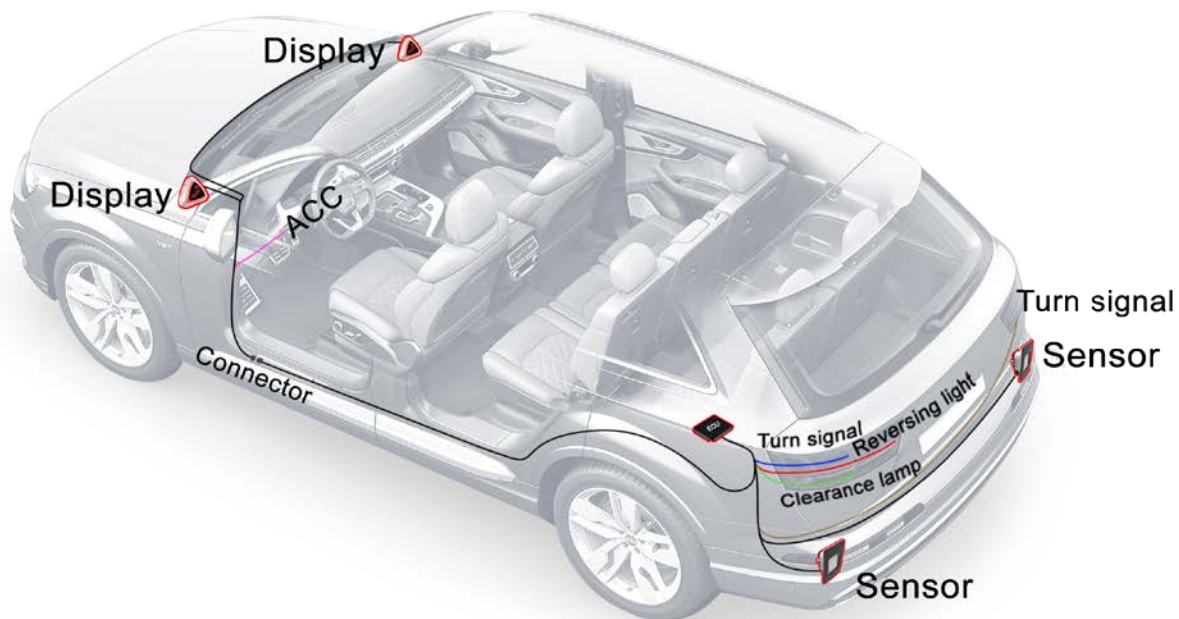

Wiring Diagram:

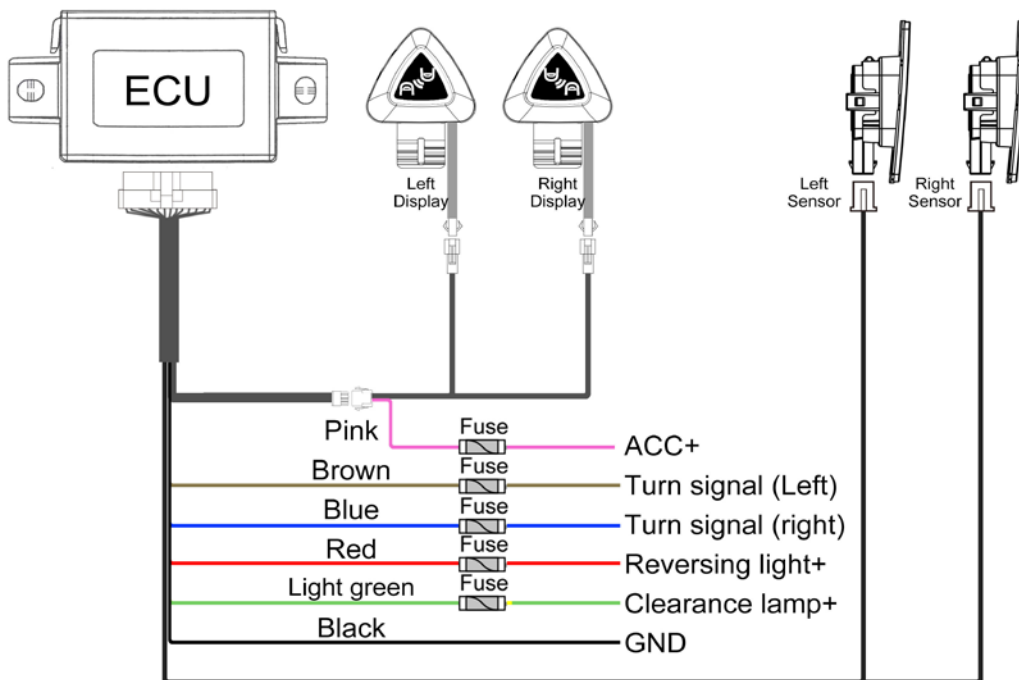

Technical Specifications:

ECU

Operating voltage	DC 9~30V (Compatibility with 12 & 24 volt system)
Operating current	<300mA
Operating temperature	-40°C~+85°C / -40°F~+185°F
Storage temperature	-40°C~+85°C / -40°F~+185°F

Sensor

Sensor operating frequency	77~81GHz
Operating temperature	-40°C~+85°C / -40°F~+185°F
Storage temperature	-40°C~+85°C / -40°F~+185°F
Sensor IP rate	IP67
Sensor maximum detection range	≥5 meters / 16.4 ft
Installation height	55±10 cm / 1.8±0.3 ft
Sensor detection accuracy	±5 °C / ± 41 °F
Sensor relative speed range	>5 km/h and <40 km/h / 3.1 mph and 24.9 mph
Weight	19±2 g

Display

Buzzer sound frequency	1KHz ± 0.1KHz
Operating temperature	-20°C~+70°C / -4°F~+158°F
Storage temperature	-40°C~+85°C / -40°F~+185°F